



# TRANSCENDENCE

*A Complete Civil Engineering Consultancy*

# About Us

Transcendence is one of the leading Civil Engineering consultancy in Vijayawada, Andhra Pradesh founded in the year 2002 by MR. VANGARA SRINIVASA RAO.

- We offer wide range of civil engineering services satisfying our distinguished and elite clients.
- With an exceptional team of engineers and other workforce, we undertake prominent projects across our nation and deliver them all efficiently.

## Our Vision

Our aim is to establish Transcendence as a **LEADING CIVIL AND STRUCTURAL ENGINEERING CONSULTANCY** through diversification across various sectors

- We envision to build strong connections across the globe, extend our complimentary services to charitable organizations
- And contribute in the projects that help to build our nation sustainably

## Our Mission

We offer our services to our clients with high quality and integrity using the latest construction techniques and software packages.

We value resources and effectively utilize them to complete the projects within the desired time frame.

We, as a team, focus on dealing each one of our projects with the same commitment and dedication, and strive to shape our client's dream into reality.

## SERVICES



### Architectural

Perfect planning and architectural design is our basic trait in shaping the clients dreams



### Structural Designs

We design structures with utmost stability and durability using latest technologies. Economy is our prime concept



### Statutory Approvals

With right approach as per the prevailing Government orders we get permissions within the timeline



### Project Management

For any project we make sure proper time scheduling, cost control, good supervision and safety of workforce



### Surveying

We assist in selection of site and study the feasibility of the project for which it is intended to



### Interiors and Acoustics

Our passion in interiors & acoustics design, make the outcome nothing short of fabulous!



### MEP

Our ideal design ensures safety of the entire system, long lasting and maintainance free with minimum wastage & economical design



### 3D Visualisation

Our Exterior rendering, Interior rendering, 3D animated walkthrough makes an extraordinary architectural presentation

## CHEIF CONSULTANT



*Mr. V. Srinivasa Rao*

### **36 YEARS OF EXPERIENCE AS A CIVIL STRUCTURAL CONSULTANT**

Founder Sri V. Srinivasa Rao is a Post Graduate from a reputed institute, PSG College of Technology, Coimbatore, in Civil Engineering with specialization in Structures.

He worked for more than a decade in **STATE GOVERNMENT AS A ENGINEER** and had wide exposure in designing and constructing various types of steel and RCC structures.

He is associated with the construction of many huge projects in various sectors of the country.

His experience and dedication towards the profession, makes him stand apart as a top-notch civil engineer.

One of his key strengths is his expertise in rehabilitation and retrofitting of structures

## Our Team

### ARCHITECTURAL

Architect  
Jr.Architect  
CAD Engineer  
3D Designer

### STRUCTURAL

Sr.Structural Engineer  
Jr.Structural Engineer  
CAD Engineer

### PROJECT MANAGEMENT

Sr. Project Managers

Jr. Project Managers

Project Planners  
Site Engineers  
Site Supervisors  
QC Engineer

### MEP

Sr.PH Engineer  
PH Engineer  
Electrical Engineer  
CAD Engineer

### STATUTORY APPROVAL

Sr.Co-ordinator  
CAD Engineer

## Lead Consultant



**Ms. V. Prathyusha**

She deals with Architectural planning, Structural Designs and 3D visualization. Her creative thinking and constant hardwork help clients achieve their vision

**12 years of experience in both Architectural and Structural designs**

- Ms. Prathyusha is a Structural Engineer with **M-Tech, Structures** in IIT, Hyderabad.
- She has completed her **CEO Programme** in IIM, Lucknow
- With great passion towards architecture and sustainable design, she achieved **TPA Licence** from APECBCB for **energy efficient design** of buildings

## Our Key Personnel



**Ratna Kumar**  
Chief Co-ordinator



**Ravi Kumar**  
Sr.Project Manager



**Chakradhar**  
Sr.Project Manager



**Ravi Kumar**  
Electrical Consultant



**Anil Kumar**  
Plumbing Consultant



**Samuel Prabhakar**  
Interiors & Acoustics



# **RESIDENTIAL PROJECTS**

## RESIDENTIAL



## GREEN ORBIT HOMES



### Description :

- It is large gated community with 4 high rise towers, club house and a Hotel block in an extent of Ac.6.0. at Tallavalasa Visakhapatnam.
- Towers are of declining height 36 floors, 34 floors, 32 floors and 30 floors respectively.
- The total gated community consists of 380 duplex flats .
- It has many amenities like Swimming Pool, Yoga and meditation center, Sports Facilities, Multi-purpose Hall, shuttle court, Super Market, Mini Theater, Environmental deck on upper podium .

Built-up Area : 16 lakh sqft

Location :Visakhapatnam, Andhra Pradesh





**SOUTH VIEW**

**CLUB HOUSE WEST VIEW**





**HOTEL FRONT VIEW**

**BIRD EYE VIEW**



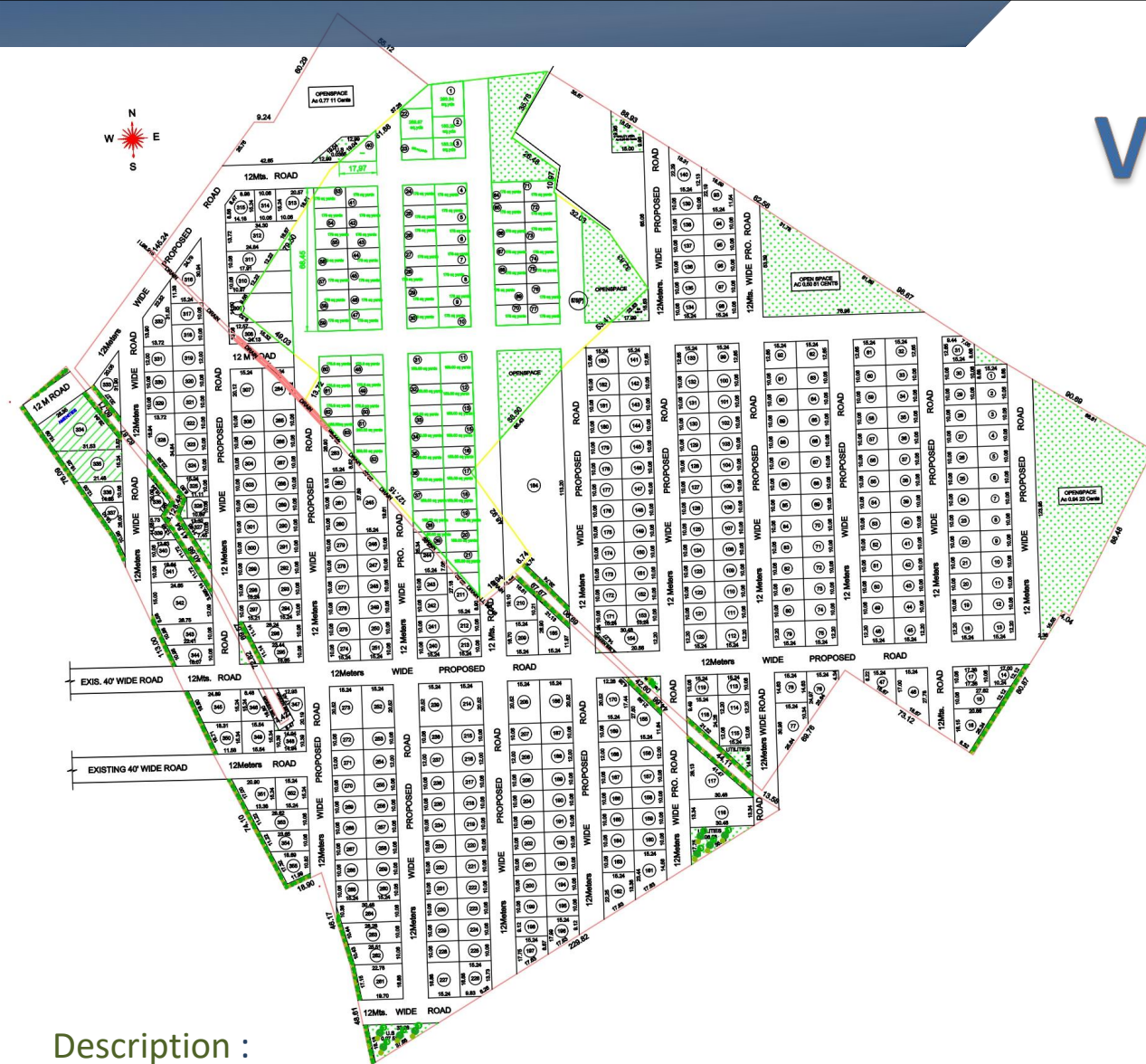

# VENKATAPURAM LAYOUT

## Description :

- The layout consists of 43 acres of land
- Our scope involves preparation of layout and plotting.
- The total gated community consists of 443 plots.
- Single floor 2BHK AND 3BHK villas and duplexes are designed and proposed in the above layout
- Amenities like parks, play areas, OHT etc., are designed and provided
- Roads, drains, underground drains, water supply lines, electrical lines are designed and provided
- culverts, cable trenches, CC roads and footpaths with kerbs are provided in the layout

Location : Eluru, Andhra Pradesh



SERVICES RENDERED:

## STRUCTURAL DESIGNS



### Description :

- GV one is a 2 Acres gated community with total 116 flats.
- It consists of Basement+6 Floors.
- It has many features like Swimming Pool, Amphitheater, Sports Facilities, Multi-purpose Hall, Super Market, Mini Theater etc

Built-up Area : 3 lakh sqft

Location :Bhimadole, Andhra Pradesh

# SERENITY HABITAT & PAAVNA ENCLAVE

SERVICES RENDERED:  
ARCHITECTURAL PLANS & ELEVATIONS, STRUCTURAL DESIGNS, MEP, STATUTORY  
APPROVALS, 3D ANIMATION WALKTHROUGH



## Description :

- Serenity Habitat & Paavna Enclave are luxurious 4BHK and 3BHK flats respectively
- It consists of Stilt+5 Floors R.C.C. Structure with ample car parking.

Built-up Area : 80,000 sqft

Location : Vijayawada, Andhra Pradesh

SERVICES RENDERED:

## STRUCTURAL DESIGNS



*Phase 1*



### Description :

- Vivaan Villas are large housing spaces spreading over an area of 10 acres.
- 64 Villas in Phase I & 24 Villas are Phase II.
- These R.C.C. buildings are G+2 each but had many complexities like huge cantilevers, floating columns with no. of architectural restrictions

Built-up Area : Varies with each villa

Location :Vijayawada, Andhra Pradesh

*Phase 11*



**SERVICES RENDERED:  
ARCHITECTURAL PLANS & ELEVATIONS, STRUCTURAL DESIGNS, MEP, PROJ.  
MANAGEMENT CONSULTANCY, STATUTORY APPROVALS**

## SRMT RESIDENTIAL



Description : R.C.C. Building with residential apartments with 130 flats  
Built-up Area : 2.60 lakh sqft  
Location :Kakinada, A.P

**SERVICES RENDERED:**  
**ARCHITECTURAL PLANS & ELEVATIONS, STRUCTURAL DESIGNS, MEP, PROJ.**  
**MANAGEMENT CONSULTANCY, STATUTORY APPROVALS**

## JAMACCSL HOUSING



Description : It is a massive housing project in an extent of 4.08 acres with 485 flats in total. It consists of 5 blocks, each block of Stilt+ G+4 floors.

Built-up Area :6 lakh sqft

Location :Autonagar, Vijayawada



**SERVICES RENDERED:**  
**ARCHITECTURAL PLANS & ELEVATIONS, STATUTORY APPROVALS,**  
**STRUCTURAL DESIGNS, MEP, PROJ. MANAGEMENT CONSULTANCY**

# RAJASHREE GARDENS

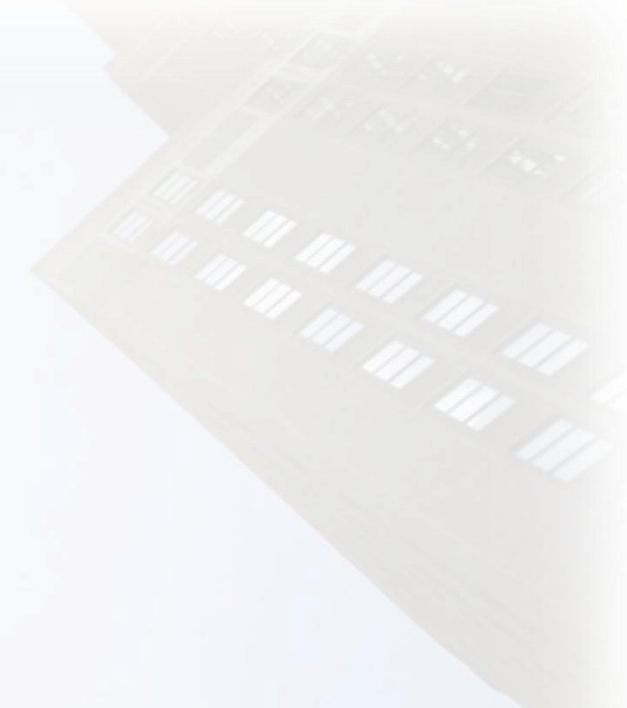

Description : High Rise building with residential apartments and a club house  
Built-up Area : 3.4 lakh sqft  
Location :Poranki, VJA, A.P.



SERVICES RENDERED:

## STRUCTURAL DESIGNS

# RELIANCE ISLAND GARDERNS



Description : High Rise Building with Residential block and a club house

Built-up Area : 2.2Lakh sqft

Location :Ramachandra Nagar, VJA



SERVICES RENDERED:  
STRUCTURAL DESIGNS

# Sustainable Villas



Resort @ Karjat, Mumbai



Vinod Krishnan Residence @ Chennai



Ravi Mehta Villa @ Mumbai



*In collaboration with Mulberry Architects, Mumbai we render PEB structural design service for luxury villas and resorts which are energy efficient at minimum cost for sustainable living*



Description : G+2 R.C.C. building in an extent of 10 acres land  
Built-up Area : 30,000 sft  
Location :Perisepalli, VJA

## FEW OTHER RESIDENTIAL PROJECTS



### SIRI ENCLAVE

Description: Residential Apartments  
Built-up Area : 1.35 lakh sqft  
Location :Bhavanipuram, VJA, A.P.



### SIRI ICONIC TOWERS

Description : Apartment Complex  
Built-up Area : 75,000 sqft  
Location :Gollapudi, VJA, A.P.



### CASA EUPORIA

Description :Apartment Complex with residential block and a club house  
Built-up Area : 2.6Lakh sqft  
Location :Mangalagiri, A.P.



### SRUJANA AND SANJANA

Description : Apartment Complex  
Built-up Area : 1.3 lakhsqft  
Location :Guntupalli,Vijayawada



### SURYA ENCLAVE

Description : Apartment Complex  
Built-up Area : 32,000 sqft  
Location :Nunna, near Vijayawada



### TRIPURANENI HABITAT

Description : R.C.C. Building with residential apartments.  
Built-up Area : 70,000 sqft  
Location :Muralinagar, VJA,A.P.



# **COMMERCIAL PROJECTS**

# CASA KIA SHOWROOM

SERVICES RENDERED:

STATUTORY APPROVALS, STRUCTURAL  
DESIGNS, PMC

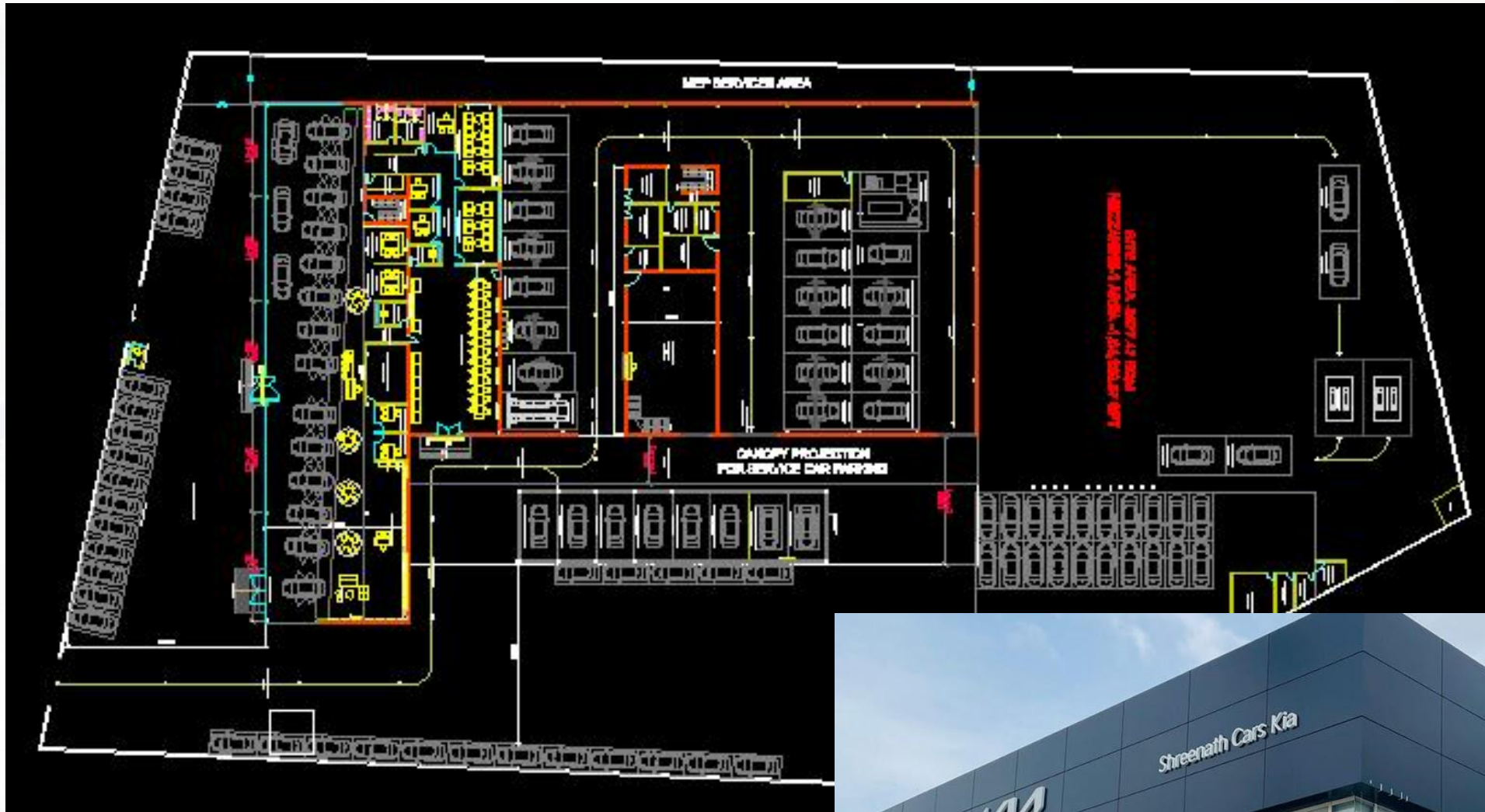

Description : CAR SHOWROOM  
Built-up Area : 51,000 sqft  
Location : Prasadampadu, Vijayawada



# KOLAR WARE HOUSE SHED

SERVICES RENDERED:  
**STRUCTURAL DESIGNS, MEP, PMC**



Description : WARE HOUSE  
Built-up Area : 2.2 Lakh sqft  
Location :

SERVICES RENDERED:

# STRUCTURAL DESIGNS

## VIVAAN CLUB HOUSE



Description : Club House  
Built-up Area : 60,000 sqft  
Location :New Auto Nagar, VJA



**SERVICES RENDERED:  
ARCHITECTURAL PLANS & ELEVATIONS, STRUCTURAL DESIGNS,  
MEP, STATUTORY APPROVALS**

## TANKASALA GATE WAY



Description : Shopping Mall & Hotel  
Area : 50,000 sqft  
Location :Enikepadu,VJA, A.P.



Description : Popular Badminton Academy In Vijayawada  
Area : 25,000 sqft  
Location :Gurunanak colony, VJA

# HEMANTH RESTAURANT & COFFEE SHOP

SERVICES RENDERED:

## STRUCTURAL DESIGNS



Description : High End Coffee Shop and Restaurant with large parking space  
Built-up Area : 20,000 sqft  
Location :New Autonagar, VJA





# **EDUCATIONAL PROJECTS**

## EDUCATIONAL



### HAPPY VALLEY INTERNATIONAL

**Description :** International School with Academic Block, Residential Block, Swimming pools, Auditorium etc spread over in 40 acres.

**Built-up Area :** 4lakh sqft

**Location :** Agiripalli. A.P.



### GOWTHAM INTERNATIONAL SCHOOL

**Description :** International School with Classrooms & Hostel buildings

**Built-up Area :** 3.50lakh sqft

**Location :** Gudavalli, A.P.



### GOWTHAM CONCEPT SCHOOL

**Description :** Concept School with Classrooms & Hostel buildings

**Built-up Area :** 2.00lakh sqft

**Location :** Gudivada, A.P.

## EDUCATIONAL



### **KENNEDY HIGH THE GLOBAL**

Description : Global School with academic blocks, hostel blocks, dining halls, swimming pools, basket ball courts, library etc.

Built-up Area : 2.2 lakh sqft

Location : Bachupally, Hyderabad



### **GOWTHAM RESIDENTIAL**

Description : It is located in an extent of 5 acres consisting of academic block , two hostel blocks , dining halls , multipurpose auditorium and swimming pool

Built-up Area : 1.80 lakh sqft

Location : Anandapuram, Visakhapatnam

### **KENNEDY INTERNATIONAL**

Description : This school campus consists of a day-scholar block with class rooms, seminar halls, a hostel block, dining halls and library.

Built-up Area : 1.80lakh sqft

Location : Kanuru, Vijayawada

# SCOTSPINE INTERNATIONAL SCHOOL



Description : International School with academic blocks, hostel blocks, dining halls, swimming pools, basket ball courts, library etc.

Built-up Area : 50,000 sqft

Location :Vijayawada, A.P.



# HOSPITALS

# LALITHA PVS. INSTITUTE OF MEDICAL SCIENCES

UPCOMING 800 BED HEALTHCARE PROJECT.....

SERVICES RENDERED:  
STRUCTURAL DESIGNS



**Description :** Lalitha Hospitals is one of the biggest private hospitals in Andhra Pradesh. It consists of 2 cellars and 8 upper floors. Transcendence once again proved its efficiency in facing no. of challenges in this project and co-ordinating with various other consultants like Architects, MEP, gas, fire.

**Built-up Area :** 11 lakh sqft

**Location :** Guntur, Andhra Pradesh



SERVICES RENDERED:  
**STRUCTURAL DESIGNS**



**MULTI-SPECIALITY  
HOSPITAL  
AT  
CHILAKALURIPET**

Description : Multi-speciality  
Hospital with  
Cellar+Ground+5 floors  
Built-up Area : 42,000sqft  
Location : Chilakaluripet,  
Andhra Pradesh

SERVICES RENDERED:

ARCHITECTURAL PLANS & ELEVATIONS, STRUCTURAL DESIGNS,

MEP, PMC



## VASANTH INTERNATIONAL DENTAL HOSPITAL

Description : Dental Hospital  
with residence at top floor. It is  
Stilt+G+3 PT building

Built-up Area : 30,000sqft

Location : Narasaraopet, Andhra  
Pradesh

## FEW OTHER HOSPITALS



### LATHA SUPER SPECIALITY

Description : Multi Speciality Hospital  
Area : 33,500 sqft  
Location :Suryaraopet, VJA, A.P.



### SUNRISE

Description : Multi Speciality Hospital  
Area : 39,500 sqft  
Location :Suryaraopet, VJA, A.P.



### SRI SWARUPA

Description : Super-Speciality Hospital  
Area : 35,000 sqft  
Location :Suryaraopet,VJA, A.P.



### ANU HOSPITALS

Description : Super-Speciality Hospital  
Area : 36,500 sqft  
Location :Vijayawada, A.P.



### DR GURU PRASAD GARU

Description : Physician's Hospital  
Area : 20,000 sqft  
Location :Vijayawada, A.P.



### RATNA HOSPITAL

Description : Super-Speciality Hospital  
Area : 12,000sqft  
Location :Vijayawada, A.P.



# **AUDITORIUMS & CONVENTION HALLS**

# AYANA CONVENTION CENTER

SERVICES RENDERED:  
STRUCTURAL DESIGNS, PMC, STATUTORY APPROVALS

Description : Biggest  
Convention Hall in and around  
Vijayawada  
Built-up Area :1 lakh sqft  
Location : Kankipadu, Near  
Vijayawada



# SVPC CONVENTION

**SERVICES RENDERED:  
ARCHITECTURAL PLANS & ELEVATIONS, STRUCTURAL DESIGNS, MEP,  
STATUTORY APPROVALS**



Description : One of the finest Convention Hall in Rajamundry.  
Built-up Area :90,000 sqft  
Location:Rajamundry, Andhra Pradesh



# SVN CONVENTION

**SERVICES RENDERED:**  
**ARCHITECTURAL PLANS & ELEVATIONS, STRUCTURAL DESIGNS, MEP,  
STATUTORY APPROVALS**



Description : CONVENTION HALL  
Built-up Area :24,000sqft  
Location :New Autonagar, Vijayawada



## FEW OTHER AUDITORIUMS AND CONVENTIONAL HALLS



### MB BHAVAN

Description : Auditorium  
Area : 50,00 sqft  
Location :M.G Road, VJA, A.P.



### JSR AUDITORIUM

Description :Auditorium  
Area : 39,500 sqft  
Location :Nellore, A.P.



### ASR AUDITORIUM

Description :Auditorium  
Area : 30,000 sqft  
Location :VSKP, A.P.



### VKP KALYANAMANDAPAM

Description : Function Hall  
Area : 24,00 sqft  
Location :Mylavaram, A.P.



### VIGNAN VIHAR

Description :Auditorium  
Built-up Area : 10,000 sqft  
Location : Nutakki,A.P.



# **INDUSTRIAL PROJECTS**

## JC GRAPHICS

**SERVICES RENDERED :Survey, Architectural, Structural, Project Management , Statutory Approval, Electrical, Plumbing**



**Description :** JC Stationery is an ITC notebook printing industry in a site area of 13 acres. The entire project consists of 1 lakh sqft godowns, 1.78 lakh sqft notebook manufacturing unit and a corporate office along with internal C.C. roads, loading base for trucks, sumps, S.T.P.s etc . Godowns and manufacturing units are large span P.E.B structures with mezzanine floors where office is an R.C.C. building with post-tensioned slabs.

**Built-up Area :**3 lakh sqft

**Location :**Kankipadu, Vijayawada



Admin Block



Manufacturing unit



Manufacturing unit with Mezzanine floor

# CASTLEROCK FISHERIES PVT. LTD. PROCESS INDUSTRY

**Description :** It is a shrimp processing industry in an extent of 10 acres with a cold storage capacity of 1600 Tons

**Built-up Area :** 1.6 lakh sqft

**Location :** Gudur, Nellore Dist., A.P.

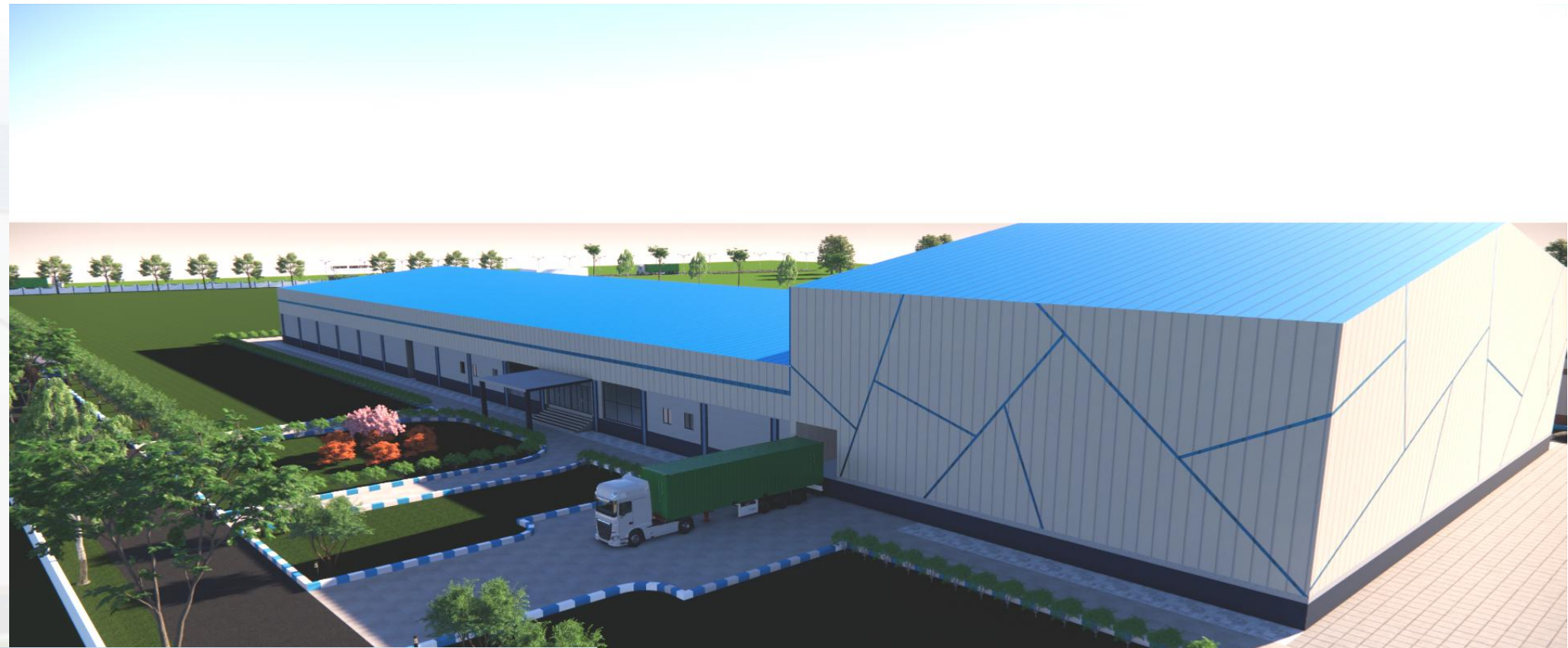

## GROWEL FEED FACTORY

**SERVICES RENDERED :Survey, Architectural, Structural, Statutory Approval, Electrical, Plumbing**



**Description :** It is a prawn and fish feed manufacturing industry. Transcendence is involved in the design of its second unit at Singarayapalem, constructed in an extent of 11 acres with a two warehouses, a 38m height main process tower which is partly an R.C.C. structure and partly a steel structure, a 40m height chimney , a boiler shed and few miscellaneous.

**Built-up Area :**2,00,000sqft

**Location :**Singarayapalem, A.P.

SERVICES RENDERED:  
**STRUCTURAL DESIGNS**

**CO. FOODS**

**FISH AND  
SHRIMP  
PROCESS UNIT**



Description : Fish & Shrimp process unit  
with 5000 tons of Cold Storage,  
Built-up Area : 1,25,000 sqft  
Location : Arugolanu , NTR Dist.

## CP FEED FACTORY

**SERVICES RENDERED :Survey, Architectural, Structural, Statutory Approval, Electrical, Plumbing**



**Description :** It is a fish and shrimp feed manufacturing industry.

**Built-up Area :** 1,30,000sqft

**Location :** Ganapavaram, A.P.

## GROWEL PROCESS

**SERVICES RENDERED :Survey, Architectural, Structural, Statutory Approval, Electrical, Plumbing**



Description : An aquatic feed process plant

Built-up Area :3,20,000sqft

Location : Singarayapalem, A.P.

# TEXTILE PARK

## SERVICES RENDERED :Structural Designs



**Description :** A textile manufacturing unit which consists of PEB structure with an area of 1,72,000 Sqft and RCC building of 21,500 Sqft in a total site area of 20 acres.

**Built-up Area :** 1,82,000sqft

**Location :** Sullurpet, Nellore, A.P.

## HINDUSTHAN COCA COLA BEVERAGES

**SERVICES RENDERED :Survey,Architectural,Structural,Statutory Approval,Project Management,Electrical,Plumbing**



**Description :** Our association with HCCB is from the year 2005. For the last 15 years, Transcendence is providing services for various expansion works at Athmakur. One of the major works is structural designs for HF line for soft drink **maaza** which is around 1 lakh sqft and was constructed within a span of 110 days.

**Built-up Area :** 4 lakh sqft

**Location :** Atmakur, Guntur.

# KOLAR WARE HOUSE SHED

SERVICES RENDERED : Structural Designs, MEP, PMC



Description : WARE HOUSE  
Built-up Area : 2.2 Lakh sqft  
Location :

## FEW OTHER INDUSTRIAL PROJECTS



### AKSHAYA PARTA

Description :A base kitchen with 1lakh meals per shift  
Built-up Area : 82,000 sqft  
Location :Mangalagiri



### NIZAMI REKHA SEA FOODS

Description :Sea Food Industry  
Built-up Area : 90,000 sqft  
Location :Kontai, West Bengal



### ZEAL AQUA

Description : Aqua feed Process  
Area :80,000 sqft  
Location :Surat, Gujarat



### SH FOOD PARK

Description :Meat processing industry  
Built-up Area : 1,20,000 sqft  
Location : Vinukonda, A.P



### AQUATICA FROZEN FOODS

Description : Sea food process  
Built-up Area : 1.40 lakh sqft  
Location :Chirala, A.P.



### VC NUTRI FOODS

Description : A Chocolate manufacturing industry with a site area about 9400sqmts  
Built-up Area : 57,500 sqft  
Location :Mallavalli, A.P.

# PROJECT MANAGEMENT CONSULTANCY

**SERVICES RENDERED :Architectural,Structural,Electrical and Project management consultancy**



## JAMACCSL HOUSING

**Description :** It is a massive housing project in an extent of 4.08 acres with 485 flats in total. It consists of 5 blocks, each block of Stilt+ G+4 floors.

**Built-up Area :**6 lakh sqft

**Location :**Autonagar, Vijayawada



# PROJECT MANAGEMENT CONSULTANCY



## AKSHAYA PARTA

**Description** :The Akshaya Patra Foundation is a non-profit organisation in India that operates a school lunch programme. The organisation was established in 2000. It aims to counter classroom hunger and aid in education of children. It feeds 1,800,907 children every day across India

**Built-up Area** : 82,000 sqft

**Location** :Mangalagiri, A.P.

## HINDUSTAN COCA COLA

**Description** :Transcendence is providing services for various expansion works at Athmakur. One of the major works is structural designs for HF line for soft drink **maaza** which is around 1 lakh sqft and was constructed within a span of 110 days. We are also involved in planning and getting approvals for the their each and every expansion work.

**Built-up Area** :1.3 lakh sqft

**Location** :Atmakur, Guntur, A.P.



# PROJECT MANAGEMENT CONSULTANCY

**SERVICES RENDERED :Architectural,Structural,Electrical and Project management consultancy**



## JC STATIONARY

**Description :** JC Stationery is an ITC notebook printing industry in a site area of 13 acres. The entire project consists of 1 lakh sqft godowns, 1.78 lakh sqft notebook manufacturing unit and a corporate office along with internal C.C. roads, loading base for trucks, sumps, S.T.P.s etc .

**Area :** 3.2 lakh sqft

**Location :** Kolavennu, Near Vijayawada, A.P.

## AYANA CONVENTIONS AND HOTEL

**Description :** It is a convention hall in an extent of 6 acres with ample car parking, an accommodation block with 40 well furnished rooms and 2 mini banquet halls of 200 capacity . The total area of main function hall is 30,000sqft and kitchen block is 15,000sqft.

**Built up Area :** 1,00,000 sqft

**Location :** Kankipadu, Vijayawada, A.P.



## THIRD PARTY CONSULTANCY

### Services Rendered: Proof Checking/Peer review

Transcendence is expert in cross checking the design calculations and co-relating with drawings.

We not only check the designs for safety, we also confirm in terms of economy, ease of execution on site.



### MID VALLEY CITY

**Description :** Proof checking for 3 high rise towers in that one is 27 storied tower and the other two are 17 storied towers

**Built-up Area :**10lakh sqft

**Location :**Mangalagiri, Guntur



### BHUVAN VIJAYAM

**Description :** Residential Apartment with G+7 upper floors

**Built-up Area :**1.80lakh sqft

**Location :**Tadepalli, Guntur

## PROJECTS IN CAPITAL CITY AMARAVATHI

### 1. RESIDENCE FOR NIVASA TRUST REPRESENTED BY SMT. NARA BRAHMANI

**Services Rendered :** CRDA Approvals and structural designs.

**Stage of work:** In Progress

### 2. Commercial complex at Mandadam belonging to Sri. M. Krishna rao

**Services Rendered:** Services rendered: Architectural plans, Approvals from APCRDA , structural designs, preparation of BOQs, MEP services and Site visits during execution.

**Stage of work:** In Progress

### 3. Show room for Varun motors pvt. Ltd (Bharat Benz )

Services rendered: Architectural plans, Approvals from APCRDA , structural designs, PEB design , preparation of BOQs and Site visits during execution.

**Stage of work:** In Progress

### 4. Show room for Varun motors Pvt. Ltd ( JCB)

Services rendered: Architectural plans, Approvals from APCRDA , structural designs, PEB design , preparation of BOQs and Site visits during execution.

**Stage of work:** In Progress

## PROJECTS DONE SO FAR

80 +

INDUSTRIAL  
PROJECTS  
COMPLETED SO FAR

4000 +

PROJECTS OTHER  
THAN INDUSTRIAL  
COMPLETED SO FAR

1000 +

CLIENTS

100 +

ONGOING  
PROJECTS

38 +

SERVICE  
EXPERIENCE

## SOME OF OUR CLIENTS



ఆంధ్రజ్యోతి



M  
HOTEL



Triton  
Consultants

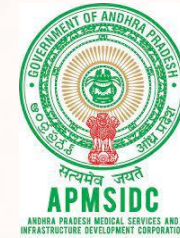

Coca-Cola  
Hindustan Coca-Cola  
Beverages Pvt. Ltd.

Ratna Group



వజ్రాశక్తి  
ప్రతి అక్షరం ప్రజల పక్షం

Growel  
FEEDS  
An ISO 9001 : 2008 Certified Company



AKSHAYA  
PĀTRA  
Unlimited food for education

JC United

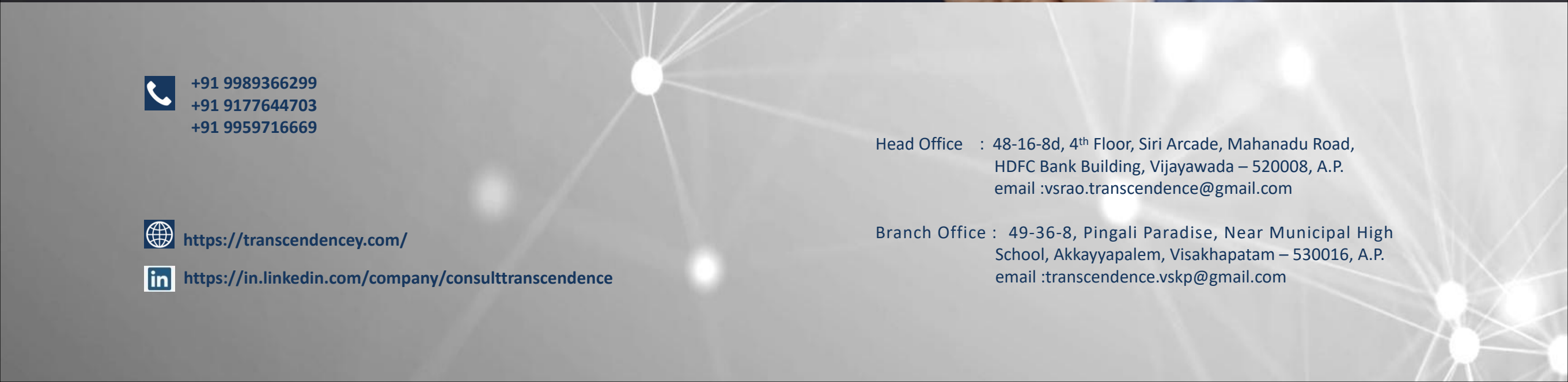

+91 9989366299  
+91 9177644703  
+91 9959716669



<https://transcendencey.com/>



<https://in.linkedin.com/company/consulttranscendence>

Head Office : 48-16-8d, 4<sup>th</sup> Floor, Siri Arcade, Mahanadu Road,  
HDFC Bank Building, Vijayawada – 520008, A.P.  
email :vsrao.transcendence@gmail.com

Branch Office : 49-36-8, Pingali Paradise, Near Municipal High  
School, Akkayyapalem, Visakhapatam – 530016, A.P.  
email :transcendence.vskp@gmail.com